



Webbs

Helping people move since 1994

Birmingham Road | Walsall | WS1 2QN

Offers Around £140,000



Summary

****TWO BEDROOM APARTMENT**GROUND FLOOR**ALLOCATED PARKING**POPULAR LOCATION**MODERN FITTED KITCHEN**MODERN FITTED BATHROOM**VIEWING ESSENTIAL****

Nestled in the desirable area of Birmingham Road, Walsall, this improved two-bedroom ground floor apartment presents an excellent opportunity for first-time buyers or savvy investors. The property boasts a prime location, with a wealth of local amenities right at your doorstep, ensuring convenience and accessibility.

Upon entering, you are greeted by a welcoming entrance hall that leads into a spacious open-plan living kitchen diner. This contemporary space features a modern fitted kitchen equipped with a selection of integrated appliances, making it ideal for both entertaining and everyday living. The apartment comprises two generous bedrooms, providing ample space for relaxation and rest. Additionally, a stylishly appointed bathroom completes the interior, offering both comfort and functionality.

Outside, residents can enjoy the well-manicured communal gardens, perfect for leisurely strolls or enjoying the fresh air. To the rear of the property, you will find allocated and covered parking, adding to the convenience of this lovely home.

Offered for sale with no chain, this apartment is a rare find in a highly sought-after postcode. With its modern features and prime location, it is sure to attract considerable interest. Do not miss the chance to make this delightful property your own.

Key Features

- TWO BEDROOMS APARTMENT
- OPEN PLAN LIVING KITCHEN DINER
- PARKING TO THE REAR
- MODERN FITTED BATHROOM
- PERFECT FIRST TIME BUY OR INVESTMENT
- GROUND FLOOR
- FINISHED TO A HIGH STANDARD THROUGHOUT
- MODERN FITTED KITCHEN
- POPULAR LOCATION
- CALL WEBBS TO SECURE YOUR VIEWING TODAY ON 01922 663399!!

Rooms and Dimensions

Entrance Hall

Sitting Dining Room

15'9" x 11'6" (4.821m x 3.518m)

Kitchen

12'1" x 7'6" (3.706m x 2.287m)

Bedroom One

11'7" x 11'11" (3.547m x 3.633m)

Bedroom Two

11'2" x 7'6" (3.409m x 2.298m)

Bathroom

7'4" x 6'2" (2.238m x 1.893m)

Identification Checks B





Webbs
Helping people move since 1994



Webbs
Helping people move since 1994



Webbs
Helping people move since 1994



Webbs
Helping people move since 1994



Webbs
Helping people move since 1994



Webbs
Helping people move since 1994

GROUND FLOOR

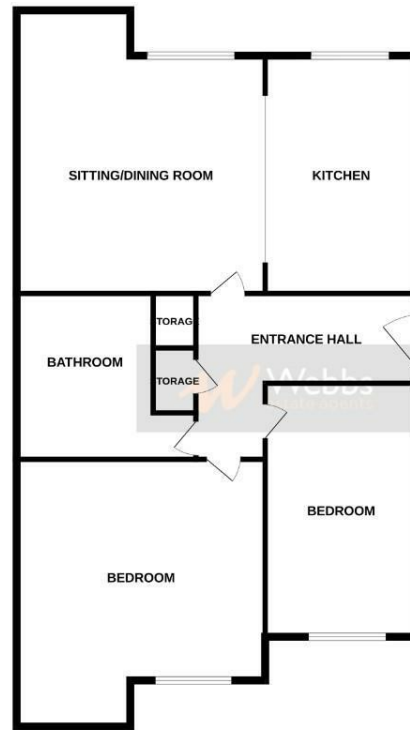

Whilst every attempt has been made to ensure the accuracy of the floorplan contained here, measurements of doors, windows, rooms and any other items are approximate and no responsibility is taken for any error, omission or mis-statement. This plan is for illustrative purposes only and should be used as such by any prospective purchaser. The services, systems and appliances shown have not been tested and no guarantee as to their operability or efficiency can be given.
Made with Metropax ©2025

Webbs Estate Agents - endeavour to maintain accurate depictions of properties in Virtual Tours, Floor Plans and descriptions, however, these are intended only as a guide and purchasers must satisfy themselves by personal inspection.

